

## Features

- Suitable for harsh environments
- Suitable for sensitive interconnections that have to be protected and shielded
- Robust metal version
- For size 6, 10, 16 and 24 with screw locking
- For each size, a variant for mounting inside and outside

## Technical characteristics

Specifications	DIN EN 61 984
Housings	
Material	aluminium die-cast corrosion resistant
Colour	RAL 9005 (black)
Surface	
- Top coat	powder-coated
Locking element	
- Screw locking	M6
- Material	stainless steel
- Tightening torque	4 Nm
Seal	
- Material	NBR
Limiting temperatures	-40 °C ... +125 °C
Corrosion resistance	ASTM B117-09 (500 h)
Protection degree acc. to DIN EN 60 529 in locked position	IP66 / IP68

# Han® HPR Panel Feed Through Housings



Identification      Cable entry      Part number      Drawing      Dimensions in mm

Han® HPR panel feed through housing for mounting from inside  
Size 6 B



1 x 40

19 40 006 1113

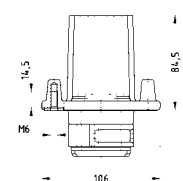
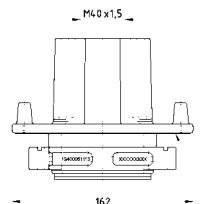

Panel cut out



Size 10 B



1 x 40

19 40 010 1113

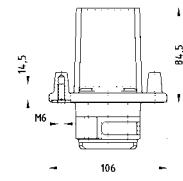
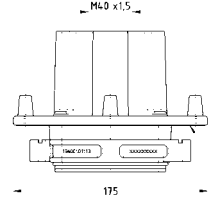

Panel cut out

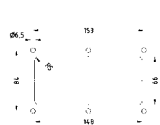

Size 16 B



1 x 50

19 40 016 1114

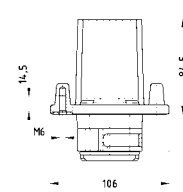
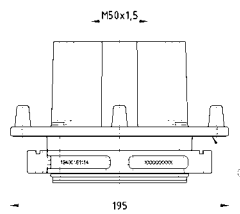

Panel cut out

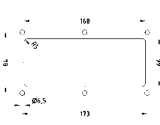

Size 24 B



1 x 50

19 40 024 1114

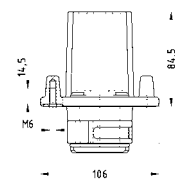
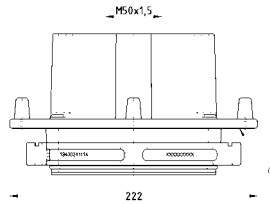

Panel cut out

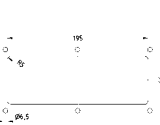

① gasket enclosed separately

# Han® HPR Panel Feed Through Housings



Identification      Cable entry      Part number      Drawing      Dimensions in mm

Han® HPR  
panel feed through  
housing for  
mounting from outside  
Size 6 B



1 x 40

19 40 006 1118

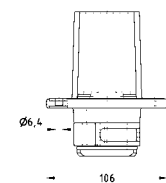
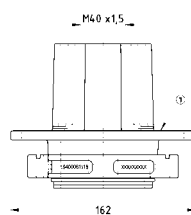

Panel cut out

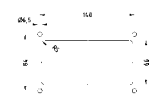

Size 10 B



1 x 40

19 40 010 1118

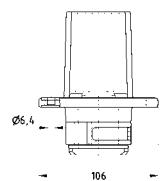
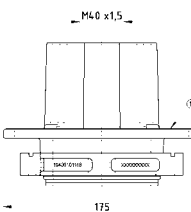

Panel cut out

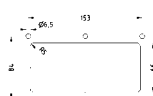

Size 16 B



1 x 50

19 40 016 1119

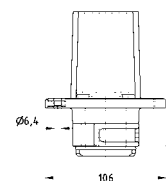
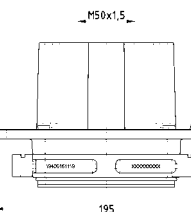

Panel cut out

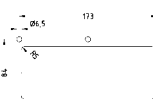

Size 24 B



1 x 50

19 40 024 1119

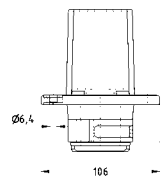
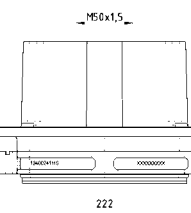

Panel cut out



① gasket enclosed separately